

ELEVATION

Sir Arthur C. Clarke Near Earth Object Observatory

SCALE: 1"=20'-0"

Conceptual Elevation

Brooke County, West Virginia

OCTOBER 4, 2007

SMG

KEY TO NOTES

- 1 ENTRY VESTIBULE
- 2 EXHIBIT SPACE
- 3 LAB/CLASSROOM/DISTANT LEARNING STUDIO
- 4 CONTROL ROOM
- 5 PLANETARIUM/OBSERVATORY
- 6 TICKET/INFORMATION COUNTERSCIENCE STORE
- 7 RETRACTABLE ROOF STORAGE POSITION (TYPICAL)
- 8 OFFICES
- 9 STAIRWELL
- 10 ELEVATOR
- 11 RESTROOMS/UTILITY SPACE/STORAGE
- 12 ROOFTOP OBSERVATION DECK
- 13 ENTRY PLAZA

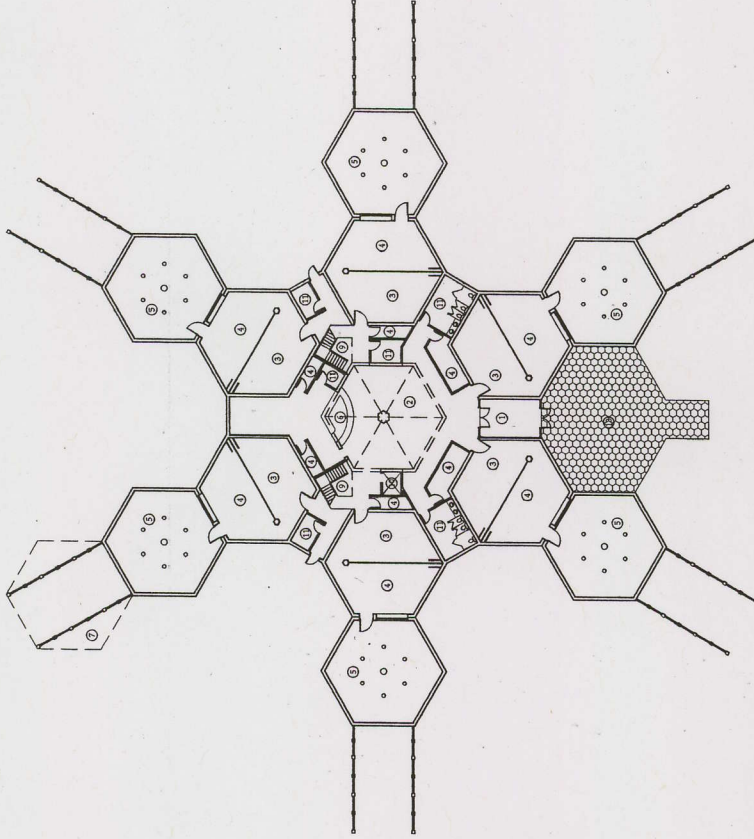

ENTRY LEVEL PLAN

Sir Arthur C. Clarke Near Earth Object Observatory

SCALE: 1"=40'-0"

Conceptual Floorplans

Brooke County, West Virginia

OCTOBER 4, 2007

SMG

KEY TO NOTES

- 1 ENTRY VESTIBULE
- 2 EXHIBIT SPACE
- 3 LAB/CLASSROOM/DISTANT LEARNING STUDIO
- 4 CONTROL ROOM
- 5 PLANETARIUM/OBSERVATORY
- 6 TICKET/INFORMATION COUNTERSCIENCE STORE
- 7 RETRACTABLE ROOF STORAGE POSITION (TYPICAL)
- 8 OFFICES
- 9 STAIRWELL
- 10 ELEVATOR
- 11 RESTROOMS/UTILITY SPACE/STORAGE
- 12 ROOFTOP OBSERVATION DECK
- 13 ENTRY PLAZA

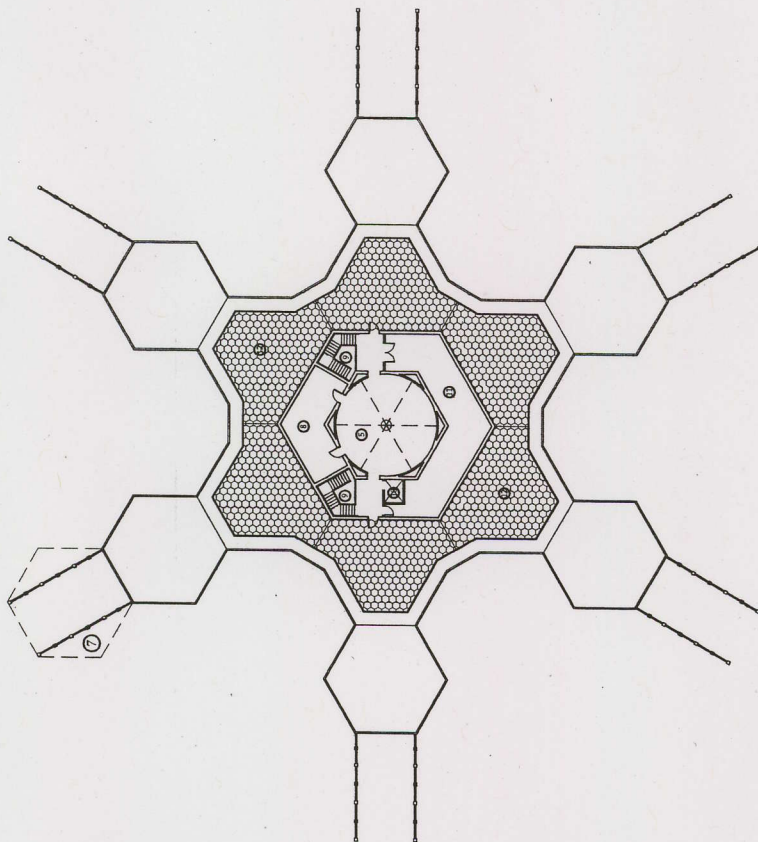

SECOND LEVEL PLAN

Sir Arthur C. Clarke Near Earth Object Observatory

SCALE: 1"=40'-0"

Conceptual Floorplans

Brooke County, West Virginia

OCTOBER 4, 2007

SMG

October 4, 2007

**NEAR EARTH OBJECT FOUNDATION
SIR ARTHUR C. CLARK NEAR EARTH OBJECT OBSERVATORY**

PRELIMINARY COST ESTIMATE

Entry Level

- Entry, Exhibit space, Ticket info counter, Science store,
Storage/Utility Rooms and Restrooms \$ 707,300.00
- Control Room, Classroom, Observatory rooms \$ 2,894,000.00

Upper Level

- Offices, Storage/Utility Rooms \$ 303,300.00
- Observatory (Ash-dome) \$ 243,100.00
- Rooftop Deck \$ 150,500.00

Other

- Elevator \$ 98,400.00
- Casework allowance \$ 46,300.00

Architectural/Engineering Fees \$ 355,400.00

Subtotal \$ 4,798,300.00

Equipment*

- Telescopes \$ 1,234,000.00
- Computers/Software \$ 463,100.00
- Ancillary Equipment (Digital video cameras) \$ 578,800.00
- Furnishings for Classrooms \$ 243,100.00
- Hands on Exhibits \$ 138,900.00

Sitework

- Parking, landscaping, grading, drainage (allowance) \$ 289,400.00
- 5 interactive/educational trails \$ 152,800.00

Subtotal \$ 7,898,400.00

Contingency (7.5%) \$ 592,500.00

Total \$ 8,490,900.00

MARYLAND:

1016 MORTON ST
BALTIMORE, MD 21201
TEL 410.685.3582
FAX 410.625.4790

WEST VIRGINIA:

14TH & CHAPLINE ST
SUITE 505
WHEELING, WV 26003
TEL 304.233.0048
FAX 304.233.7564
WWW.SMGARCH.COM

* Ash-Dome Observatory included in building price.

